

# Sliding Patio Door

*Model 5100 Fusion-Welded Patio Door*



*Exceptional design for enhanced energy efficiency.*

**Alside**<sup>®</sup>

# Durability and Energy Efficiency All in One Door

*Model 5100 Sliding Patio Door provides an exceptional, energy-efficient choice for today's light-filled homes and multi-family structures.*



1. **Mainframe and sash extrusions will never chip, peel, crack or warp.** Made with premium raw materials, the vinyl color is formulated throughout so the beautiful luster lasts.
2. **Fully weatherstripped** at jambs, header and sill for improved energy efficiency.
3. **Extra-deep weatherstripped integral interlocks** at meeting stiles for added protection against air infiltration.
4. **Vertical sash components** are metal reinforced for added structural strength.
5. **Insulated glass<sup>†</sup> unit featuring double-strength glass** with optimal air space improves year-round performance.
6. **Panels** slide on dual adjustable steel wheels with steel ball bearings for smooth movement.

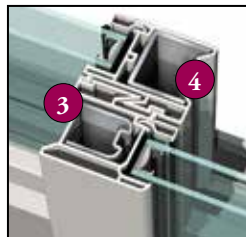

## *Plus these additional features:*

- State-of-the-art fusion-welded sashes and mainframe.
- Heavy-duty aluminum screen with four-point roller adjustment.
- Available in white or beige with left or right operating panel.
- Available in a 2-lite style in 5', 6' and 8' widths; and a 3-lite style in a 9' width.

## *Enhance your patio doors with these options:*

- ClimaTech<sup>®</sup> insulated glass package options featuring Low-E glass and the Intercept<sup>®</sup> Warm-Edge Spacer System for enhanced insulating performance.
- Colonial or contoured grids between the panes for easy cleaning.
- Specialty grooved glass panels for a truly custom look.
- Keyed exterior lock for easy access.
- Interior vent foot lock keeps door in place for minimal ventilation and security.
- Brass interior handset adds elegance and style to any décor.

## *Go Green*

Exceptionally energy-smart and weathertight, Alside Windows not only help reduce fuel consumption needed to heat and cool homes, they also boast a long service life and achieve optimal material use and minimal waste in production. The majority of all in-plant vinyl scrap is recycled into other useful products, further reducing the environmental impact of waste. As well, a principal component in the production of vinyl is salt,<sup>1</sup> a sustainable and abundant natural resource!

<sup>1</sup>The Vinyl Institute, [www.vinylinfo.org/resources/diagrams-vinyl-resin-processing/](http://www.vinylinfo.org/resources/diagrams-vinyl-resin-processing/) (accessed 1-21-21).



**Alside**

Alside 3773 State Road Cuyahoga Falls, Ohio 44223  
1-800-922-6009 [www.alside.com](http://www.alside.com)

©2021 Alside. Alside and ClimaTech are registered trademarks of Associated Materials, LLC. ENERGY STAR name and logo are registered U.S. marks and are owned by the U.S. government. Intercept is a registered trademark of Vitro Architectural Glass. <sup>†</sup>Insulated glass (IG) units that require capillary tubes may experience some argon gas depletion. All specifications and designs subject to change without notice. Printed in USA 03/21 1M/OP 75-2014-01



USGBC and related logo is a trademark owned by the U.S. Green Building Council.



Alside offers a variety of ENERGY STAR<sup>®</sup> qualified products. Consult your window professional for the optimal glass package required for your home and climate zone.

