

Sliding Patio Door

Model 6100 Premium Vinyl Patio Door



A beautiful combination of style and comfort.

Alside[®]

Combine Indoor and Outdoor Living

Alside 6100 Series Patio Doors feature a solid construction and easy-glide operation to ensure years of exceptional durability and maintenance-free performance.



1. **Mainframe and sash extrusions will never chip, peel, crack or warp.** Made with premium raw materials, the vinyl color is formulated throughout so the beautiful luster lasts.
2. **White pine wood mainframe substructure,** combined with vinyl cladding, provides an effective thermal barrier.
3. **High-performance insulated glass unit** featuring double-strength glass promotes energy conservation year-round.*
4. **Dual durometer glazing system** absorbs shocks and offers extra weather protection.
5. **Structural composite roller system** ensures quiet and easy operation of the door panel.
6. **Low-profile, anodized aluminum sill cover** for added strength and durability.
7. **Extra-deep weatherstripped integral interlocks at meeting stiles** for added protection against air infiltration.
8. **Vertical sash components** are metal-reinforced for added structural strength.

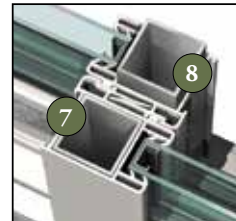
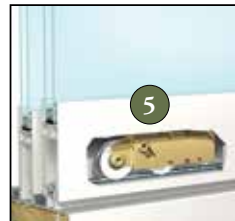

Plus these additional features:

- Triple-screw, butt-joint frame construction provides fortified strength, with no drafty gaps at corners.
- Double weatherstripping and vinyl bulb seal deliver superior weather resistance.
- Heavy-duty fiberglass screen with aluminum frame features an adjustable independent wheel system in all four corners and a controlled, spring-tension system for smooth sliding without derailment.
- Available in a 2-lite style in 5', 6' and 8' widths.

Enhance your patio doors with these options:

- ClimaTech® insulated glass package options featuring Low-E glass and the Intercept® Warm-Edge Spacer System for greater insulating performance.*
- Flat or contoured grids between the panes for easy cleaning.
- Specialty V-grooved glass panels create a subtle touch of refinement.
- Keyed exterior lock provides convenient access from outside the home.
- Interior vent foot lock keeps door in place while allowing refreshing airflow.
- Decorative interior handsets add elegance and style to any décor.
- White integrated mini blinds offer convenient sunlight and privacy control.

Alside

Alside 3773 State Road Cuyahoga Falls, Ohio 44223
1-800-922-6009 www.alside.com

©2021 Alside. Alside and ClimaTech are registered trademarks of Associated Materials, LLC. ENERGY STAR name and logo are registered U.S. marks and are owned by the U.S. government. Intercept is a registered trademark of Vitro Architectural Glass. *Energy savings will vary. See your Alside Sales Representative for additional information regarding insulated glass package performance. Insulated glass (IG) units that require capillary tubes may experience some argon gas depletion. Colors may be slightly different from their appearance in this brochure. Make final color selections using actual product samples. All specifications and designs subject to change without notice. Printed in USA 12/21 2.5M/OP 75-2810-01

Colors

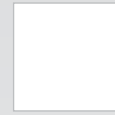

White



Beige

Interior Grids

Grid Patterns:



Colonial



Diamond



Prairie

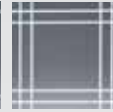

Double Prairie

Grid Profiles:



Flat White



Flat Beige



Contoured White



Contoured Beige

V-Grooved Cut Glass



Colonial



Prairie

Simulated Divided Lites



1-1/4" with mill finish shadow bar



7/8" with mill finish shadow bar

Optional Handle Finishes



Bright Brass



Antique Brass



Brushed Chrome



USGBC
MEMBER

USGBC and related logo is a trademark owned by the U.S. Green Building Council.



ENERGY STAR
PARTNER

Alside offers a variety of ENERGY STAR® qualified products. Consult your window professional to help you choose the best glass package to meet ENERGY STAR requirements for your home and climate zone.



Please recycle